



CALL FOR TRADE EXHIBITIONS

NSW Minerals Council

Environment & Community Conference

16-18 November 2008

York Fairmont Resort, Leura, Blue Mountains

The NSW Minerals Council (NSWMC) annual Environment & Community conference attracts around 250 delegates from the NSW minerals industry, consultants, and representatives from government, industry partners and the community. It is an important conference for practitioners and mine managers to address environment and community issues facing the State's \$12 billion minerals industry.

The theme for this year's Conference - "Game Plan 21: Tactics for the Times" - recognises that our industry can meet the challenges of the 21st century through adopting tactics and solutions that are readily available. The Conference aims to shine a light on immediate, positive actions the industry can undertake, rather than wait for large step-changes that are currently in development.

NSWMC is offering relevant suppliers and providers of environmental management and community relations the opportunity to market their organisation to conference delegates.

There will be 10 Trade Exhibition Booths each measuring 3m x 2m.

The exhibitions will be located in the lobby of the York Fairmont Resort. This will offer high visibility for all conference delegates. In addition all functions, breakouts, and morning/afternoon teas will be held next to the Trade Exhibitions.

The key times for the trade exhibition will be Sunday evening (welcome drinks), Monday morning, morning and afternoon teas (coffee and breakouts), Monday lunchtime, Monday evening (pre-dinner drinks), and Tuesday morning, morning tea (coffee and breakouts), Tuesday lunchtime.

To further increase delegate involvement with the Trade Exhibition there will be a prize draw for conference delegates who have visited every display and completed their trade show 'passport', which will be drawn at the end of the conference on Tuesday afternoon. Once your company has secured a trade exhibition you will be entitled to a satchel insert of your choice.

The cost for each trade exhibition will be as follows:

Exhibitions 1 - 4	\$2,600 + GST
Exhibitions 5 - 10	\$2,200 + GST

Please see the attached floor plan to determine your preferred exhibition location.



Trade Exhibition Entitlements:

- 3m x 2m booth with sufficient 240v power
- Company name and logo signage on booth
- Insert of choice in the conference satchel
- One conference satchel

Trade Exhibition Extras:

The Trade exhibitor will be able to hire plasma screens, DVD players, colour televisions, VHS players, CD players, small PA systems, and microphones from the AV contractors at an additional cost to the Trade Display space. Alternatively, exhibitors may bring their own equipment.

Trade exhibitors will be able to select their preferred Trade Display space based on the attached floor plan. These will be allocated on a first come basis.

Trade exhibitors are required to purchase a Conference package of \$200 which includes morning/afternoon tea and luncheons for both days and pre-dinner drinks on Sunday 16 and Monday 17 November. Conference sessions and dinners can be purchased at an additional cost.

Interested suppliers are asked to provide a brief Expression of Interest for an exhibition space at this year's Conference by **Friday 12 August 2008**.

TIMETABLE

12 August 2008	Final deadline for submission of Expressions of Interest.
19 August 2008	Written notice of acceptance.
9 September 2008	Notification to successful applicants from Trade Exhibition supplier to arrange individual AV requirements.

Please forward Expression of Interest and all enquiries to:

NSWMC Environment and Community Conference
C/o Jan Cornay
NSW Minerals Council
PO Box A244 SYDNEY SOUTH NSW 1235
Tel: (02) 9274 1408 Fax: (02) 9274 1455
Email: jcornay@nswmin.com.au

**Expression of Interest form including 3 exhibition preferences and contact details,
should be forwarded to the above address by
12 August 2008**

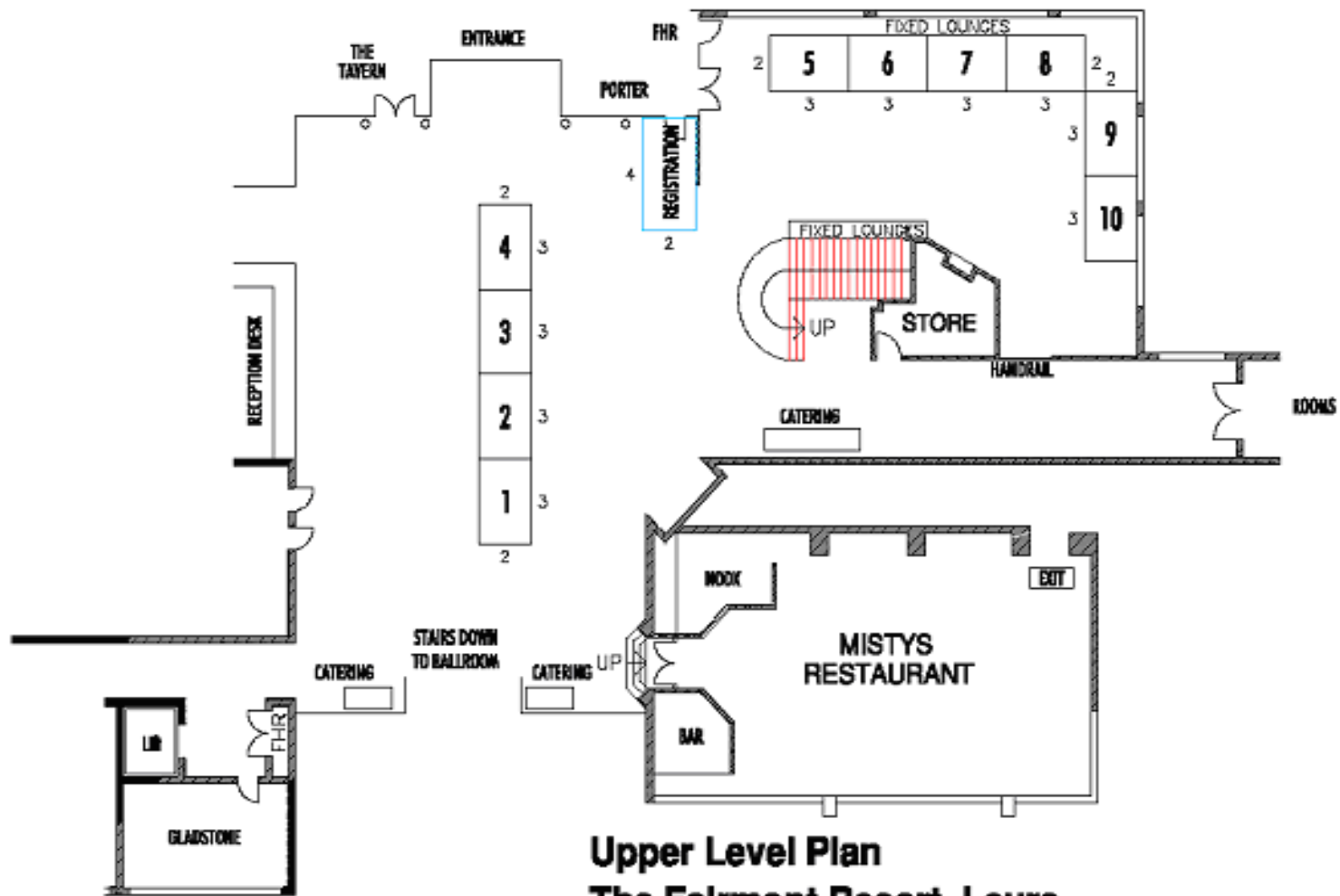

Upper Level Plan The Fairmont Resort, Leura

 **exhibition hire**
www.exhibitionhire.com.au



TITLE **NSW MINERALS COUNCIL ENVIRONMENT & COMMUNITY CONFERENCE '08**

VENUE **FAIRMONT RESORT, LEURA**
DATE **16-18 NOVEMBER 2008**

SCALE **1:500** CAD **SJM**
DWG **EX/2008/Fairmont/Leura/Conf-Hor.dwg**
DATE **2 Jul 2008** REV **5** BY **SG**

FLOOR PLAN IS SUBJECT TO VISUAL APPROVAL

COPYRIGHT RESERVED



TRADE EXHIBITION

NSW Minerals Council
Environment & Community Conference
16-18 November 2008

EXPRESSION OF INTEREST

Name: _____

Company/Institution/Government Agency: _____

Position: _____

Postal Address: _____

Suburb: _____

State: _____

Postcode: _____

Phone: _____

Mobile: _____

Email: _____

Exhibition Preference 1: _____

Exhibition Preference 2: _____

Exhibition Preference 3: _____

Audio Visual Equipment Requirements: _____

Please send this expression of interest form to:

jcornay@nswmin.com.au

Deadline for Entries
12 August 2008